

42 Turning Leaf Drive



Lot 227 Autumn Woods - Pittsford, NY



42 Turning Leaf Drive

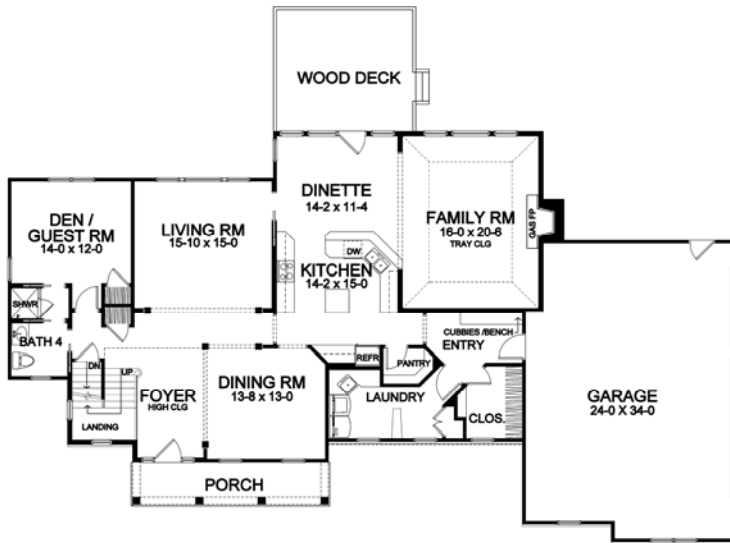

First Floor

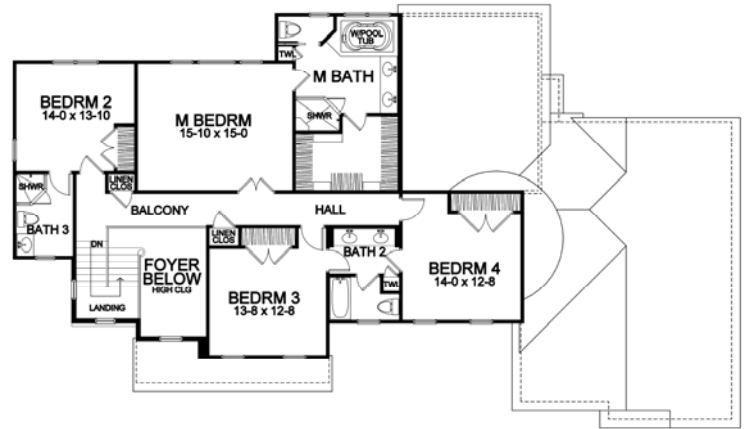

Second Floor



42 Turning Leaf Drive (Lot 227)
Home Specifications

- Square Footage:
 - First Floor 1,936
 - Second Floor 1,465
 - Total 3,401
- Three-Car Side-Load Garage
- Stone and Shutters Accent Front
- Unfinished Daylight Basement
- Four Bedrooms
- Four Bathrooms
- Grand Two Story Foyer
- Formal Living Room and Dining Room with Custom Panelized Boxed Columns
- First Floor Den/Guest Bedroom with Access to Full Bath
- Family Room with Gas Fireplace and High Tray Ceiling
- Wood-Mode Kitchen with Dinette and Walk-In Pantry
- Granite Counter Tops in Kitchen, Bath #4, and Master Bathroom
- Cubbies and Bench Seat in Garage Entry
- Large First Floor Laundry Room
- Master Suite with Oversized Closet

Home Specifications Continued...

- Stained Wide Plank Red Oak Hardwood Floors in Foyer, Dining Room, Living Room, Kitchen/Dinette, and Pantry
- Tile Floors in Baths, Entry, and Laundry
- Crown Moldings in Dining Room, Living Room, Foyer, and Upper Hall
- Master Bathroom with Whirlpool Tub and Huge Shower
- Hot Water Recirculation System for Instant Hot Water in Showers and Sinks
- 95% Efficient Trane Variable Speed Furnace for Superior Comfort and Energy Efficiency
- "Level 5" Spray Plaster Drywall Finish for Smoother, More Durable Walls and Ceilings
- Low Maintenance Exterior Trex Composite Deck and Railing
- Security System, Asphalt Driveway, and Professional Landscaping
- Many Upgrades Included
- NY State Energy Star Labeled Home



585-586-0953